



TIMBER SALE

We, Hairston Forestry Consultants, Inc., representing **Jay Simpson**, solicit bids for all merchantable timber as designated on the tract described below:

Tract Description

Approximately 72 acres of timber as shown on the attached map and described as:

Pt. S½ of SE¼, Pt. NW¼ of SE¼, Section 9, Township 7
North, Range 6 East, Scott County, Mississippi

Timber Estimate

The following timber estimate is based on a 10% sample cruise:

Pine Chip-N-Saw	988.4 Tons
Pine Pulpwood	442.5 Tons
Hardwood Pulpwood	112.1 Tons
Hardwood Sawtimber	9.160 Thousands of board feet, Doyle scale
Pine Sawtimber	640.920 Thousands of board feet, Doyle scale

Bid Information

Bids must be made on a lump-sum basis. Owners reserve the right to reject any or all bids. Bids must be received at the following address no later than **10:00a.m. on August 28th, 2025**: SIMPSON TRACT, C/O HAIRSTON FORESTRY CONSULTANTS, INC., 4016 HWY 80, PELAHATCHIE, MS 39145. You may also fax a bid to 601+854-7005 or email a bid to hairstonforestry@bellsouth.net. Please confirm that we have received your bid. Neither the owner nor their agent guarantees the estimated timber volumes contained in this timber sale prospectus.

Sale Conditions

The deadline for cutting and removing the timber will be September 30, 2027. Notification must be given to agent or owners prior to cutting. All roads and firelanes as shown on the attached map must be repaired to as good or better than their present condition when logging is completed. No excessive rutting or damage to the land will be permitted. All tops must be removed from the open areas and fire lanes when logging is completed. All merchantable timber may be cut within the clear-cut area as shown on the attached map. Mississippi BMP's should be followed. Any severance taxes due must be paid by the purchaser.

If you have any questions, or if you would like us to show you the property, then please feel free to call us.

Sincerely,

Buddy Hairston
HAIRSTON FORESTRY CONSULTANTS, INC.

Simpson Tract

Pine Sawtimber (10% Sample)	DBH		14	16	18	20	22	24	26	28	30	32	34	36	38	40	Totals
	Pine	# Trees	1,960	1,730	670	110	30	10	0	0	0	0	0	0	0	0	4,510
		Volume	191.080	263.680	140.810	28.800	10.250	6.300	0.000	0.000	0.000	0.000	0.000	0.000	0.000	0.000	640.920
Hardwood Sawtimber (10% Sample)	White Oak	# Trees	10	0	10	0	0	10	0	0	0	0	0	0	0	0	30
		Volume	0.750	0.000	1.640	0.000	0.000	3.700	0.000	0.000	0.000	0.000	0.000	0.000	0.000	0.000	6.090
	Gum	# Trees	10	20	0	0	0	0	0	0	0	0	0	0	0	0	30
		Volume	0.750	2.320	0.000	0.000	0.000	0.000	0.000	0.000	0.000	0.000	0.000	0.000	0.000	0.000	3.070
	Total Hardwood	# Trees	20	20	10	0	0	10	0	0	0	0	0	0	0	0	60
		Volume	1.500	2.320	1.640	0.000	0.000	3.700	0.000	0.000	0.000	0.000	0.000	0.000	0.000	0.000	9.160

Chip-N-Saw (10% Sample)	DBH		10	12	Total
	Pine	# Trees	520	1,240	1,760
		Volume	217.4	771.0	988.4

Pulpwood (10% Sample)	DBH		6	8	10	12	14	16	Total
	Pine	# Trees	50	430	320	160	60	30	1,050
		Volume	5.6	112.9	133.8	99.5	54.0	36.6	442.5
	Hardwood	# Trees	150	110	80	50	20	0	410
		Volume	13.9	25.2	29.5	27.4	16.1	0.0	112.1

All Sawtimber volumes are given in MBF (thousand board feet)
All Chip-N-Saw and Pulpwood volumes are given in standard tons

Timbered Acres 72
Sawtimber Volume Per Acre 9.029
Pulpwood & Chip Saw Volume Per Acre 21.4

Simpson Tract

Section 9, Township 7 North, Range 6 East, Scott County MS

Timber Sale Map

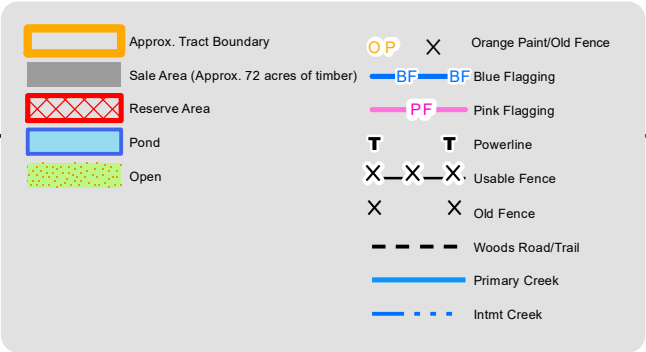
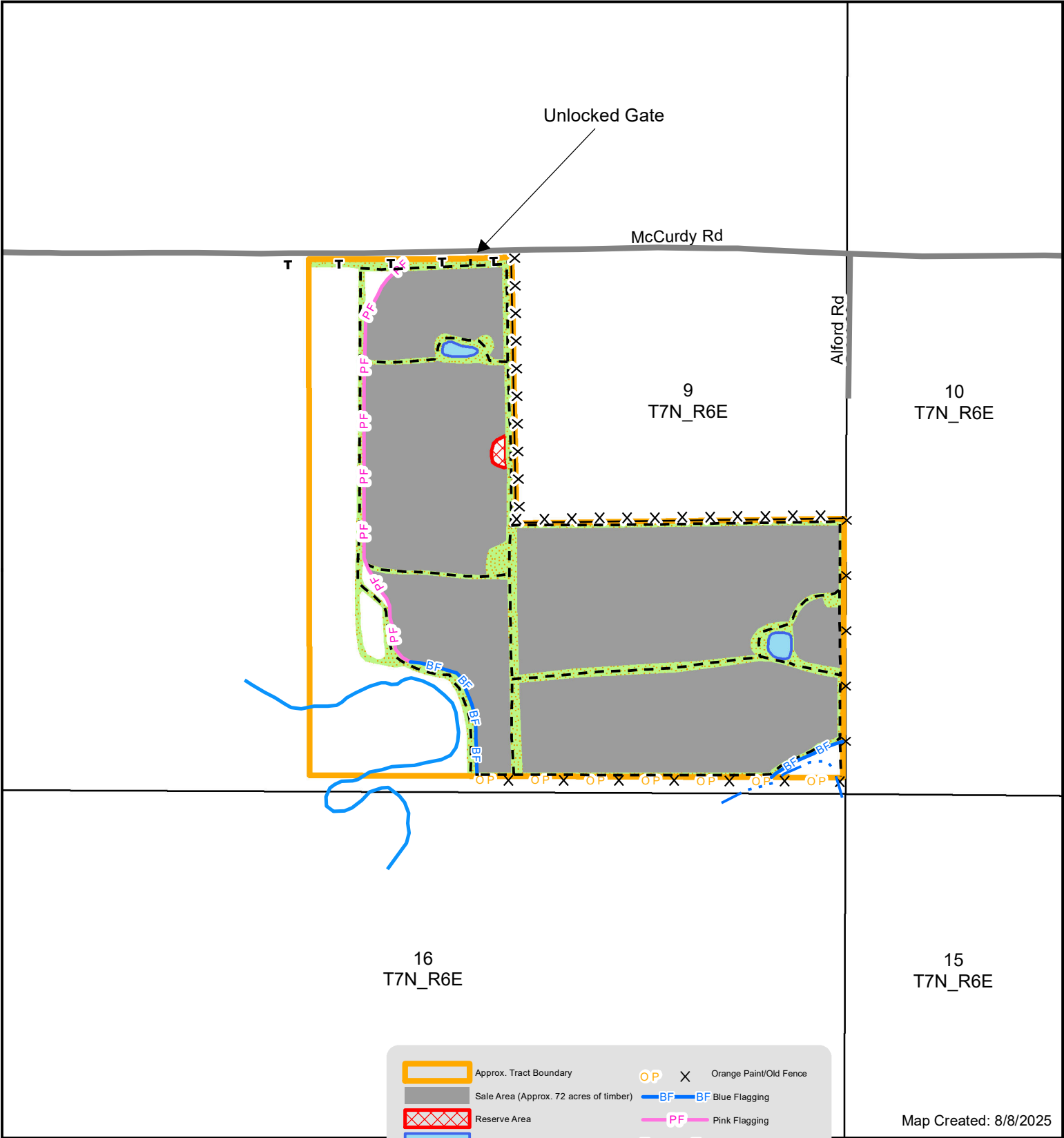

1 inch = 660 feet

Simpson Tract

Section 9, Township 7 North, Range 6 East, Scott County MS

Location Map

