

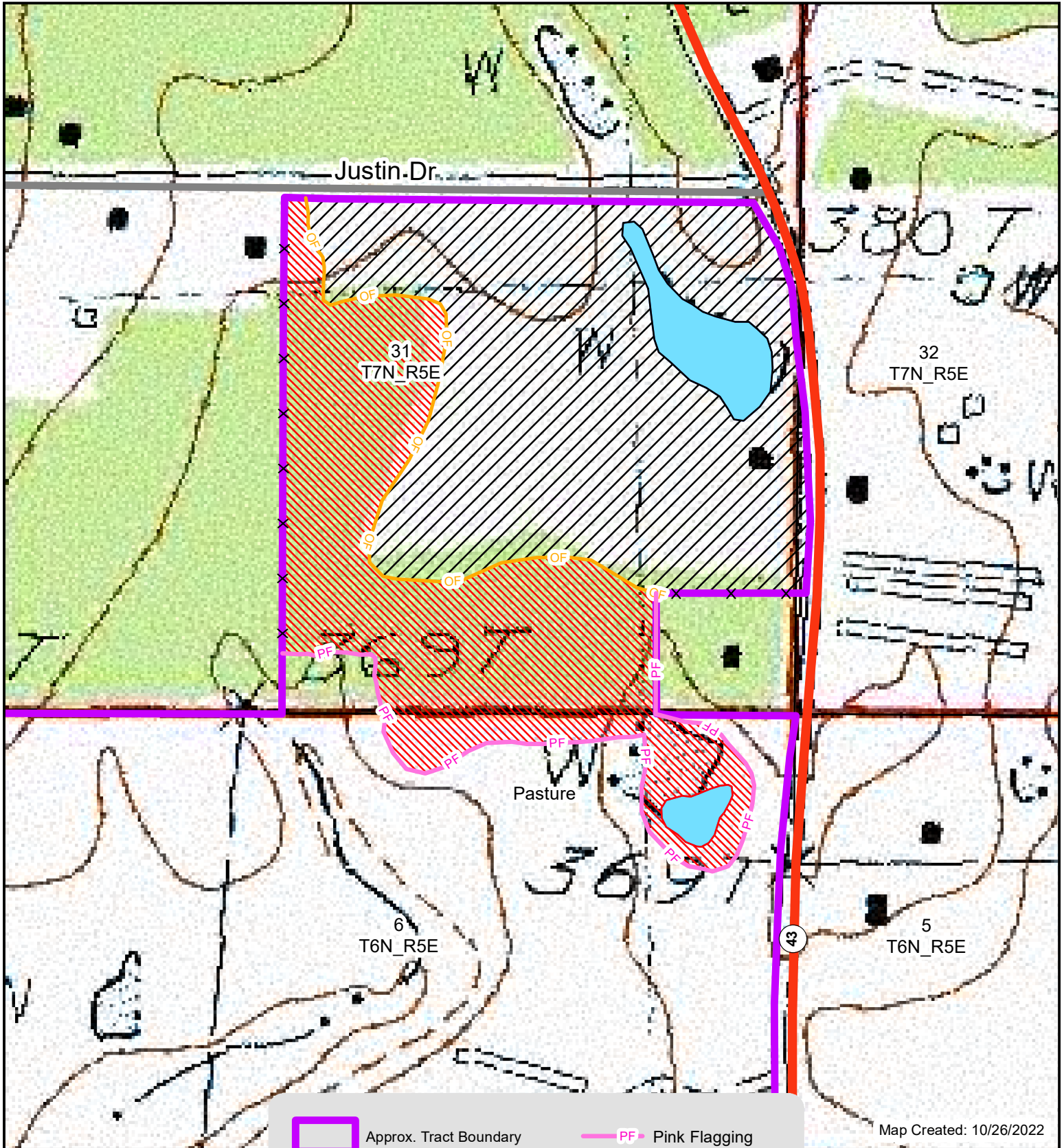

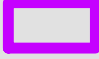



# Adams Tract

Section 31 & 6, Township 7 North, Range 5 East, Rankin County MS

Topo Map

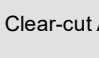

-  Approx. Tract Boundary
-  Clear-cut Area (Approx. 21 ac)
-  Select-cut Area (Approx. 15 ac)
-  Pond
-  Pink Flagging
-  Orange Flagging
-  Old Fence



www.HairstonForestry.com



1 inch = 330 feet