



TIMBER SALE PROSPECTUS

We, Hairston Forestry Consultants, Inc., representing LARRY & JANE MYERS solicit bids for all merchantable timber as designated on the tract described below:

Tract Description

Approximately 42 acres of timber as shown on the attached map and described as:

Pt. of the W $\frac{1}{2}$ of SE $\frac{1}{4}$, Section 15, Township 5 North, Range 4
East, Rankin County, Mississippi

Timber Estimate

The following pulpwood and chip-n-saw estimate is based on a 10% sample cruise:

Pine Chip-N-Saw	78.9 tons
Pine Pulpwood	51.2 tons
Hardwood Pulpwood	520.9 tons

The following sawtimber estimate is based on a 100% count:

Pine Sawtimber	110.247 thousand board feet, Doyle scale
Red Oak	54.755
Cherrybark Oak	44.742
White Oak	16.016
Post Oak	1.902
Poplar	15.159
Sycamore	3.351
Elm	1.164
Misc. Hardwood	1.599
Total Hardwood	187.389 thousand board feet, Doyle scale
Total Sawtimber	297.636 thousand board feet, Doyle scale

Bid Information

Bids must be made on a lump-sum basis. Owner reserves the right to reject any or all bids. Bids must be received at the following address no later than **10:00a.m. on June 12, 2024**: MYERS TRACT, C/O HAIRSTON FORESTRY CONSULTANTS, INC., 4016 HWY 80, PELAHATCHIE, MS 39145. You may also fax a bid to 601-854-7005 or email a bid to hairstonforestry@bellsouth.net. Please confirm that we have received your bid. Neither the Owner nor their agent guarantees the estimated timber volumes contained in this timber sale prospectus.

Sale Conditions

Owner will provide access to a public road. The deadline for cutting and removing the timber will be June 30, 2027. Notification must be given to agent or owner prior to cutting. All merchantable timber may be cut within the clear-cut sale area as shown on the attached map. Only timber marked with orange paint may be cut within the select-cut sale area shown on the attached map. No excessive rutting or damage to the land will be permitted. The atv trail shown on the attached map must be cleared at the end of the logging job. In addition, tops must be removed at least 60 feet away from the south boundary line (old water line is located there that landowner would like to maintain). Mississippi BMP's should be followed. Any severance taxes due must be paid by the purchaser.

If you have any questions, or if you would like us to show you the property, then please feel free to call us.

Sincerely,

Buddy Hairston
HAIRSTON FORESTRY CONSULTANTS, INC.

Myers Tract

Pine Sawtimber (100% Count)	DBH		14	16	18	20	22	24	26	28	30	32	34	36	38	40	Totals
	Pine	# Trees	212	187	120	48	21	5	2	1	0	0	0	0	0	0	596
		Volume	21.466	30.895	28.901	15.662	9.057	2.580	0.820	0.866	0.000	0.000	0.000	0.000	0.000	0.000	110.247
Hardwood Sawtimber (100% Count)	Red Oak	# Trees	35	64	64	41	34	25	7	6	1	0	0	1	0	0	278
		Volume	1.788	5.972	9.049	8.865	10.177	9.488	3.820	3.903	0.658	0.000	0.000	1.035	0.000	0.000	54.755
	Cherrybark Oak	# Trees	10	23	20	21	11	19	11	11	5	0	3	1	0	1	136
		Volume	0.507	2.052	3.177	4.581	3.318	8.290	5.689	7.056	3.488	0.000	3.705	1.035	0.000	1.844	44.742
	White Oak	# Trees	26	34	23	13	9	4	2	0	1	0	0	0	0	0	112
		Volume	1.356	3.328	3.055	2.619	2.752	1.452	1.078	0.000	0.376	0.000	0.000	0.000	0.000	0.000	16.016
	Post Oak	# Trees	2	5	5	4	1	0	0	0	0	0	0	0	0	0	17
		Volume	0.088	0.375	0.529	0.749	0.161	0.000	0.000	0.000	0.000	0.000	0.000	0.000	0.000	0.000	1.902
	Gum	# Trees	55	85	69	48	20	8	3	2	1	0	0	0	0	0	291
		Volume	3.153	8.815	11.402	11.880	6.119	3.436	1.697	1.301	0.898	0.000	0.000	0.000	0.000	0.000	48.701
	Poplar	# Trees	13	21	14	12	9	2	1	0	1	1	0	0	0	0	74
		Volume	0.826	2.325	2.655	3.201	2.890	0.933	0.489	0.000	0.703	1.137	0.000	0.000	0.000	0.000	15.159
	Sycamore	# Trees	3	2	4	2	2	2	0	0	0	1	0	0	0	0	16
		Volume	0.144	0.144	0.592	0.360	0.469	0.866	0.000	0.000	0.000	0.776	0.000	0.000	0.000	0.000	3.351
	Elm	# Trees	3	4	1	0	1	0	1	0	0	0	0	0	0	0	10
		Volume	0.171	0.332	0.100	0.000	0.295	0.000	0.266	0.000	0.000	0.000	0.000	0.000	0.000	0.000	1.164
Misc. Hdwd.	# Trees	2	5	5	3	1	0	0	0	0	0	0	0	0	0	16	
	Volume	0.096	0.360	0.564	0.405	0.174	0.000	0.000	0.000	0.000	0.000	0.000	0.000	0.000	0.000	1.599	
	Total Hardwood	# Trees	149	243	205	144	88	60	25	19	9	2	3	2	0	1	950
		Volume	8.129	23.703	31.123	32.660	26.355	24.465	13.039	12.260	6.123	1.913	3.705	2.070	0.000	1.844	187.389

Chip-N-Saw (10% Sample)	DBH		10	12	Total
	Pine	# Trees	40	100	140
		Volume	16.7	62.2	78.9

Pulpwood (10% Sample)	DBH		6	8	10	12	14	16	Total
	Pine	# Trees	40	130	30	0	0	0	200
		Volume	4.5	34.1	12.5	0.0	0.0	0.0	51.2
	Hardwood	# Trees	390	480	360	260	110	10	1,610
		Volume	36.2	110.0	132.6	142.5	88.7	10.9	520.9

*All Sawtimber volumes are given in MBF (thousand board feet)
All Chip-N-Saw and Pulpwood volumes are given in standard tons*

Acres	42
Sawtimber Volume Per Acre	7.087
Pulpwood & Chip Saw Volume Per Acre	15.5

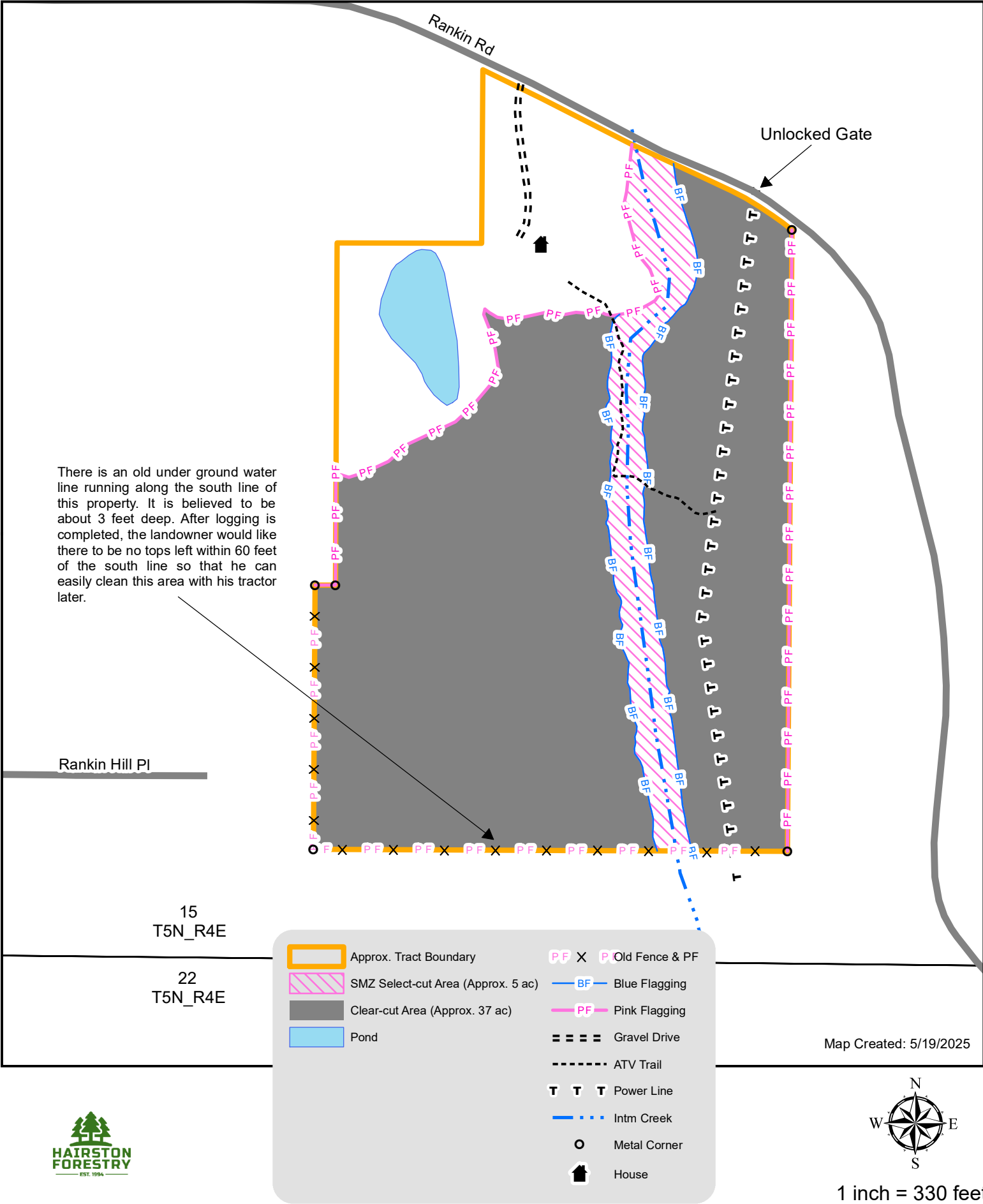

Myers Tract

Section 15, Township 5 North, Range 4 East, Rankin County, MS

Location Map

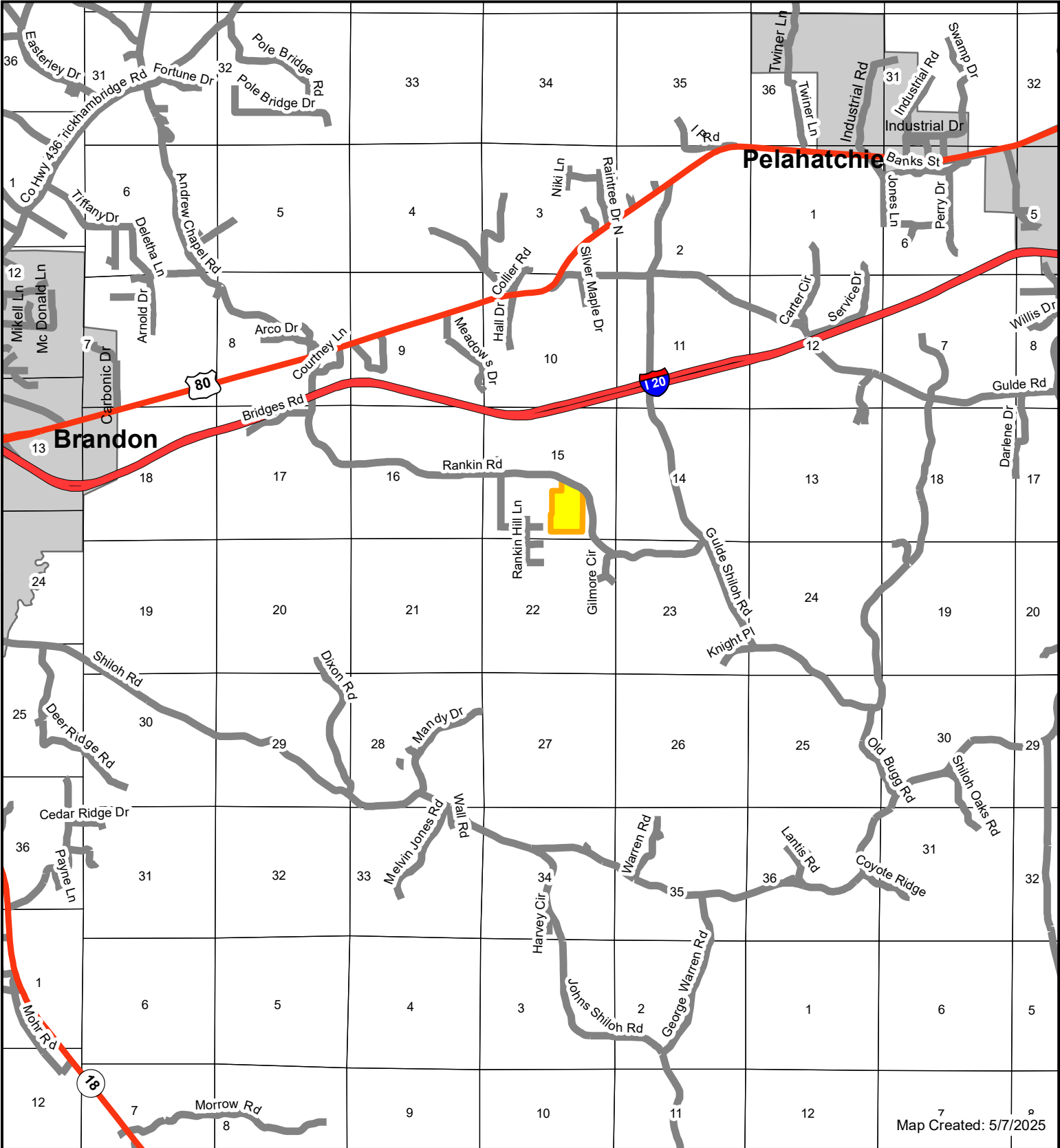

 Approx. Tract Boundary



1 inch = 5,280 feet